

# RR1-189-PAR8-3/4"TL-ANG

Trimless Angled Plaster Fixture

Project Name:		Type:	
Catalog Number:		Date:	

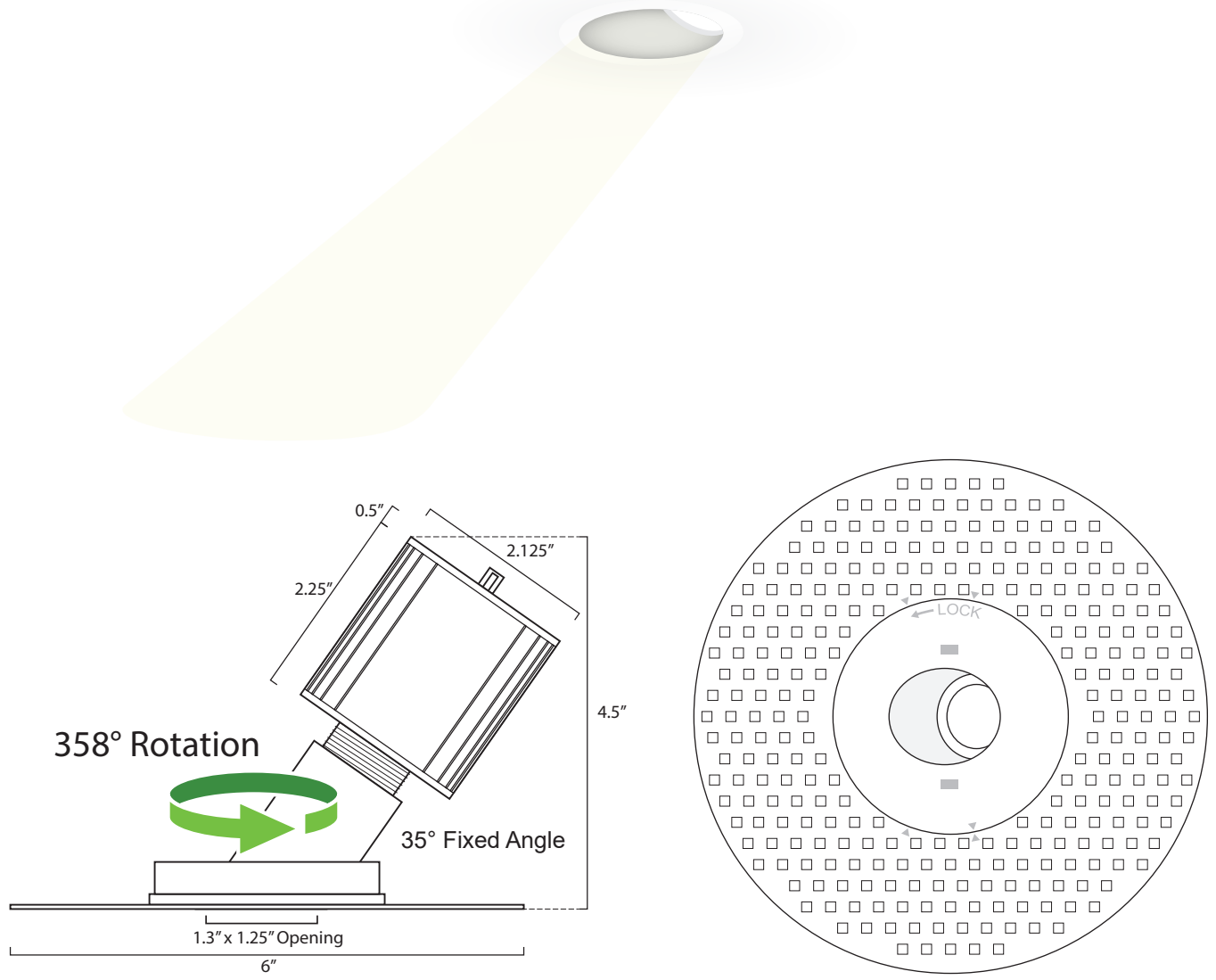

### Key Features

- 0.75" Fixture ID
- Up to 2 Accessories
- Fixed Trimless Plaster
- NON IC
- Remote Transformer
- 0.03" Trimless Screen Edge
- 100,000+ L70 life

### LED Source Details

- CREE XHP50 LED maximum rating = 1,500mA
- Fixture operating milliamp range = 300mA to 700mA.
- Operating 15% to 38% of rated value 20% to 47%
- Fixture wattage range = 5W to 17W
- Fixture delivered lumens = 500 to 1,150 lumens
- Calculated L70 CREE LED Life – 145,000 hrs\*
- Projected L70 CREE LED Life – 315,000 hrs\*

\*CREE calculated from XHP502 LM80 and TM21 data

Patent No.: US 10,208,928 B1

Last revised: 08/30/2023

# RR1-189-PAR8-3/4"TL-ANG

Trimless Angled Plaster Fixture

Project Name:		Type:	
Catalog Number:		Date:	

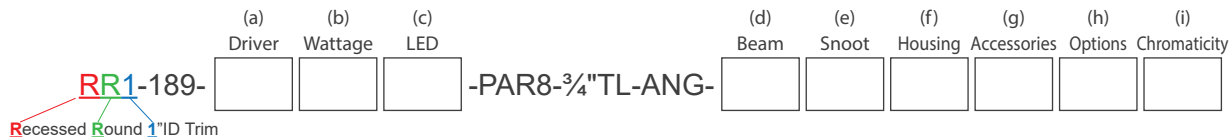

### (a) Driver Options

E	= ON/OFF (Electronic)
D	= MLV 1% Dimming (2 wire)
DC12V	= .01% PWM DC dimming (2 wire)
DC24V	= .01% PWM DC dimming (2 wire)
ED	= Electronic Reverse Phase Dimming 1% (2 wire)
0-10V1	= 0-10V 1% Dimming (3 wire)
0-10V*	= Remote mount 4 wire 0-10V LED driver single fixture
0-10V 2	= Remote mount 4 wire 0-10V driver for up to 2 fixtures
0-10V 3	= Remote mount 4 wire 0-10V driver for up to 3 fixtures
0-10V 4**	= Remote mount 4 wire 0-10V driver for up to 4 fixtures
0-10V MRI***	= 0-10V Dimming with 100bd Filter
RDM DMX	= 16 Bit, 4 Channel (2 wire with CAT5)
ABS	= Absolute Light .001% Dimming (use with RGBW)
ABSX	= DMX Absolute Light .001% RGBW dimming

\*Remote single 0-10V LED driver up to 18' away 18ga and 50' away 12ga  
 \*\*Remote 0-10V LED driver operates up to 4 fixtures up to 18' away 18ga and 50' away 12ga  
 \*\*\*Operates up to 4 recessed LED light fixtures for MRI room installation with remote LED driver

### (b) Wattage Options

5W (500 Lumens)	= ON/OFF, 0-10V 1%, ED*
7W (500 Lumens)	= MLV <1% Dimming
10W (000 Lumens)	= ABS
11W (525 Lumens)	= ON/OFF, 0-10V 1%, ED*
14W (525 Lumens)	= MLV <1% Dimming
15W (1150 Lumens)	= ON/OFF, 0-10V 1%, ED*
17W (1150 Lumens)	= MLV <1% Dimming, DMX

\*Only with no accessories.

### (c) Lamp Type Options

X4LED = Cree XHP50 LED = 50+% brighter than XLED  
 (available in spot, narrow flood, and flood)

### (d) Beam Options

SP	= Spot	NFL	= Narrow Flood
FL	= Flood		

### (e) Snoot Color Options

BLKS	= Black Snoot
WHTS	= White Snoot
PWTS	= Pewter Snoot

### (f) Fixture Housing Options

#### Non-IC Rated:

RMT	= No housing, no frame, remote transformer spring clip loaded trim
NIC	= Frame and junction box to be used with trim version

#### IC Rated:

AH	= 8" x 8" Architectural housing to be used with trimmed or level plane installation
----	---

### (g) Optical and Accessory Options

LS	= Lens Softener - +20% increase in beam width. Shields optical face visually. Softens edges of beam.	
LSL	= Linear Spread Lens - Horizontal or vertical beam elongation.	
WFL	= Wide Flood Lens - Wall washing increases the beam by 50% width with elimination of center beam.	
LV	= Louver - Small black hexcel louver eliminates all surface brightness. Creates stronger vertical cut off with -20% beam width.	
CHL	= Cross Hair Louver	
H	= Halogen - 100K warmer. 2700k to 2500K	
DH	= Dimmed Halogen - 400K warmer. 2700k to 2300K	

### (h) Options

RMT14	= 14Watt 12V AC MLV Step Down Transformer
RMT60	= 60Watt 12V AC MLV Step Down Transformer
RMT150	= 150Watt 12V AC MLV Step Down Transformer
RMT300	= 300Watt 12V AC MLV Step Down Transformer
120V	= 120VAC 60Hz (Standard)
230V	= 230VAC 50Hz
277V	= 277VAC 60Hz
347V	= 347VAC 60Hz
EMG	= 90min Emergency Back-Up Battery
TB	= DMX 5-pin Plug-in Terminal Block
RET*	= Bi-pin whip to plug Clarté LED trim module into existing MLV transformed recessed halogen MR16 fixtures.
80+	= CRI over 80
90+	= CRI over 90
EXT	= Exterior zinc primer with zinc infused paint

\*Eliminate the need to install new 12V AC step down transformer, Clarté LED trim installs like changing a lamp.

### (i) Color Temperature Options

#### White LED

22K*	= 2200 Kelvin (candlelight color)
27K	= 2700 Kelvin (incandescent color)
30K	= 3000 Kelvin (halogen color)
35K	= 3500 Kelvin (warm incandescent)
40K	= 4000 Kelvin (cool incandescent)
50K	= 5000 Kelvin (day white)
65K	= 6500 Kelvin (12 noon sunlight)

#### Colored/Themed LED

UV365**	= 365 NM UV black light
UV390**	= 390 NM UV black light
Blue*	= 465 - 485 NM wavelength
Green*	= 520 - 535 NM wavelength
Amber*	= 585 - 595NM wavelength
Red*	= 620 - 630 NM wavelength
RGBW3K***	= Red, Green, Blue, White
RGBW4K***	= Red, Green, Blue, White

\*1050 mA or less

\*\*700 mA or less

\*\*\*Must utilize DMX fixture option

# RR1-189-PAR8-3/4"TL-ANG

Trimless Angled Plaster Fixture

Project Name:		Type:	
Catalog Number:		Date:	

2-Part Design

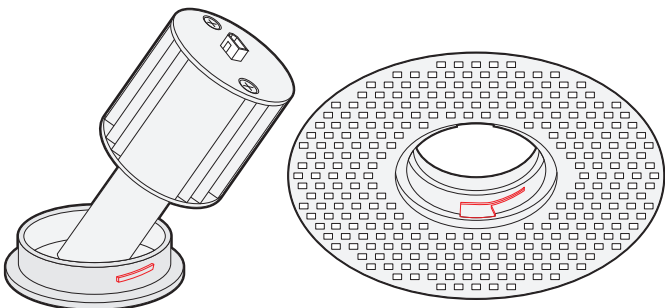

Quick and easy install.  
Line up slots and twist.

Exploded View of Parts

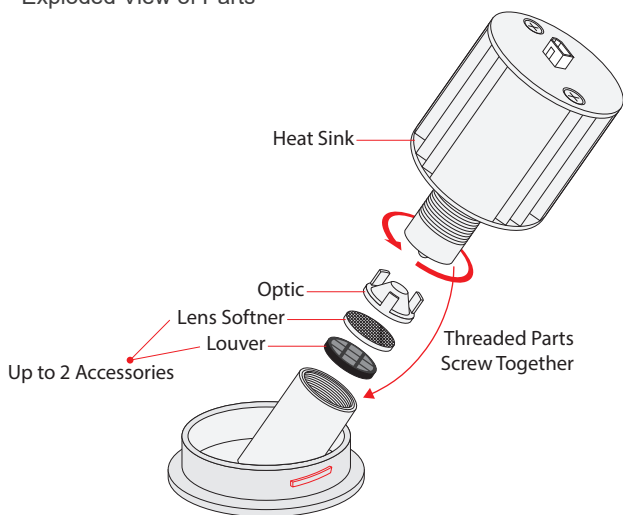

**Electrical**

- Optional - 12V AC remote class 2
- Optional - 12V or 24 DC remote class 2
- 100V, 120V, 230V, or 277V

**Heat Sync**

- 100% extruded aluminum construction

**LED**

- 1,500 maximum milliamp rated CREE XHP50 LED
- Operates between 450 to 700 milliamps
- L70 life = 100,000 hr.+

**LED Driver**

- D – 2 wire forward phase .01% LED driver fade to off glow to on
- ED – 2 wire reverse phase 1% LED driver
- DC – 12V or 24V
- 0-10V – 3 wire 1% LED driver
- Absolute Light – Remote mount class 2 48V din rail .001% LED system
- 16-bit RMD DMX – 65,536 dimming steps fade to off glow to on

**Optics**

- TIR discrete injection molded polycarbonate precision LED optic
- 45-degree vertical cut off

**Accessories**

- Up to 2 accessories

**Trimless**

- 0.03" Screen Edge
- 2-Part design for easy access to LED or driver

**Certification**

- UL Damp Listed – IP 52 – Open trim

**Warranty**

- 5 Year – ED, 0-10V, DMX and colored LED fixtures
- 7 Year – D and White LED fixtures

Quick Install Diagram

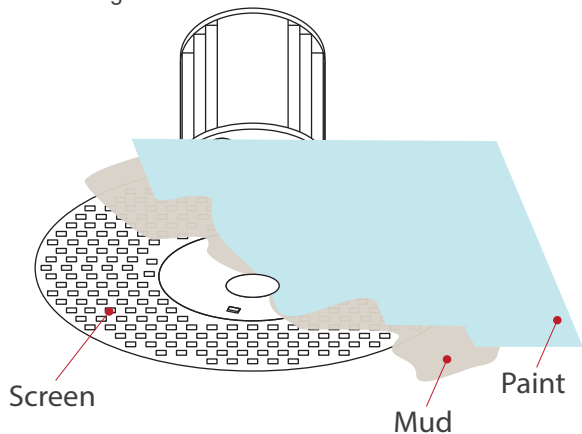

IC Architectural Housing – 100% Aluminum Housing

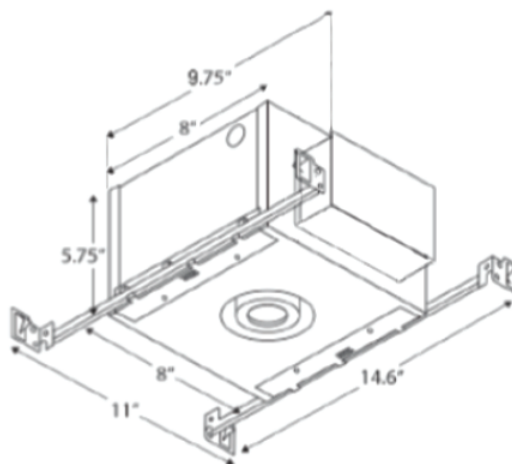

# RR1-189-PAR8-3/4"TL-ANG

Trimless Angled Plaster Fixture

Project Name:		Type:	
Catalog Number:		Date:	

### Wattage & Lumen Output

300 Milliamps - 500 Lumens		700 Milliamps		525 Milliamps - 900 Lumens		700 Milliamps - 1150 Lumens	
5W	ON/OFF 0-10V 1% Dimming ED	10W	Red - Up to 150 Lumens Green - Up to 150 Lumens Blue - Up to 150 Lumens White - Up to 300 Lumens	11W	ON/OFF 0-10V 1% Dimming ED	15W	ON/OFF 0-10V 1% Dimming ED
7W	MLV <1% Dimming			14W	MLV <1% Dimming	14W	MLV <1% Dimming DMX

### 3 Step CREE XPL2 LED

Kelvin-CRI	Multiplier
27K-80+ CRI	1
27K-90+ CRI	0.80
30K-80+ CRI	1
30K-90+ CRI	0.85
35K-80+ CRI	105
35K-90+ CRI	0.9
40K-80+ CRI	109
50K-80+ CRI	109
65K-80+ CRI	105
80+ = 84 CRI	
90+ = 94 CRI	

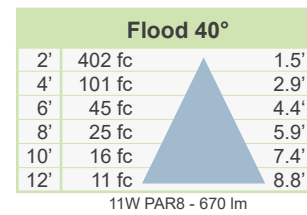
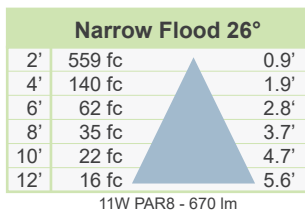

#### Zonal Flux and Percentages

Zone	%Luminaire
0-20	63
0-30	83.3
0-40	89.8
0-60	95.8
0-80	99.2
0-90	100
10-90	77.9
20-40	26.7
20-50	30.6
40-70	8
60-80	3.4
70-80	1.4
80-90	0.8

#### Zonal Flux and Percentages

Zone	%Luminaire
0-20	47.3
0-30	74.3
0-40	88.5
0-60	97.5
0-80	99.5
0-90	100
10-90	87.1
20-40	41.2
20-50	48.7
40-70	10.1
60-80	2
70-80	0.9
80-90	0.5

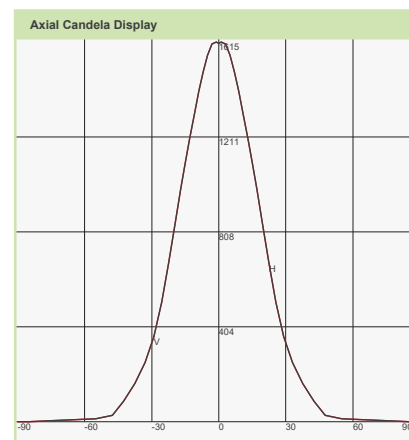
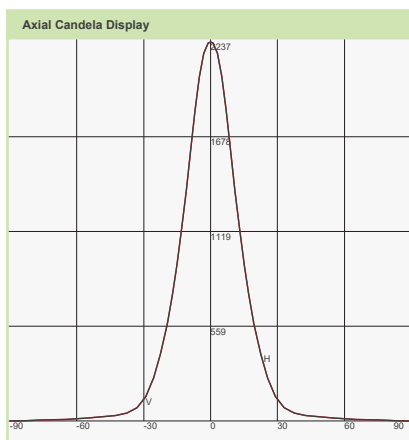

# RR1-189-PAR8-3/4"TL-ANG

Trimless Angled Plaster Fixture

Project Name:		Type:	
Catalog Number:		Date:	

## Clarté Lighting 3000K 80+ CRI Color Metrics

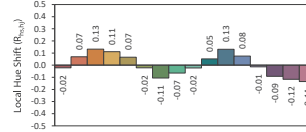
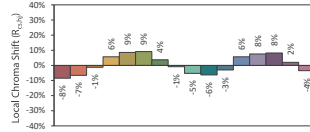
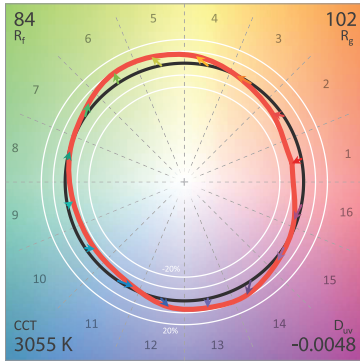

CIE 13.3-1995 (CRI)  
R<sub>a</sub> 86  
R<sub>g</sub> 29

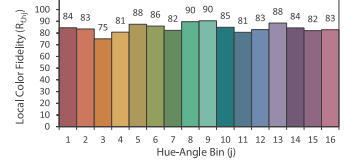
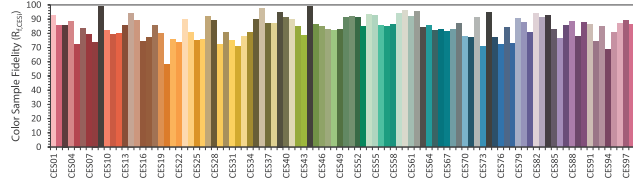

## Clarté Lighting 3000K 90+ CRI Color Metrics

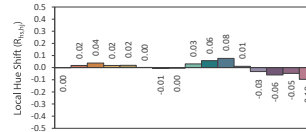
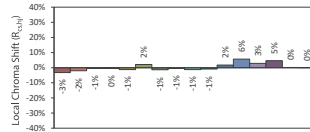
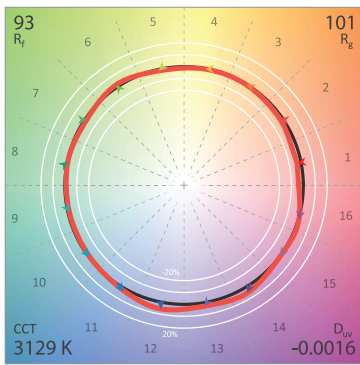

CIE 13.3-1995 (CRI)  
R<sub>a</sub> 95  
R<sub>g</sub> 74

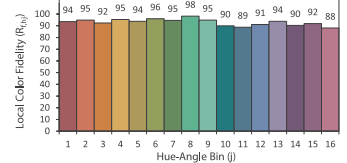
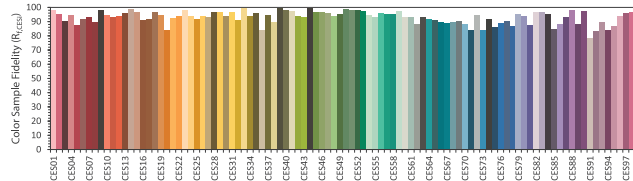

## Clarté Lighting 3000K 90+ CRI Halogen Lens (H) Color Metrics

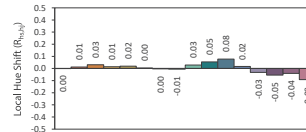
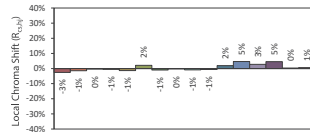
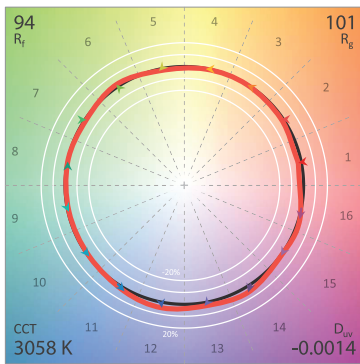

CIE 13.3-1995 (CRI)  
R<sub>a</sub> 96  
R<sub>g</sub> 79

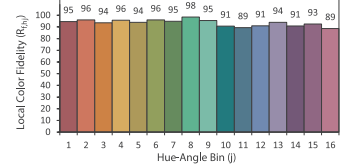
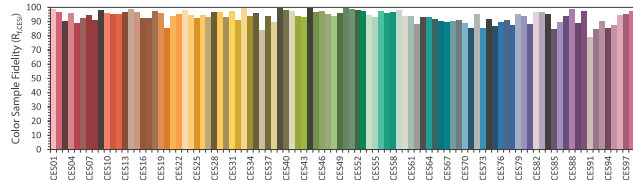

## Clarté Lighting 3000K 90+ CRI Dimmed Halogen Lens (DH) Color Metrics

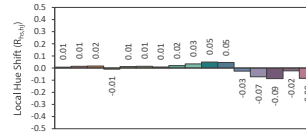
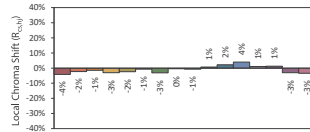
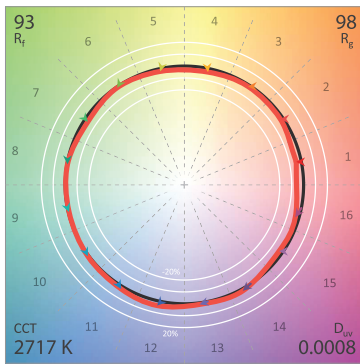

CIE 13.3-1995 (CRI)  
R<sub>a</sub> 95  
R<sub>g</sub> 64

