

PAR16 Trimless Flush Mount ABS

CLARTÉ™
LIGHTING

Absolute Light Installation Instructions for Wood & Concrete Ceiling

CAUTION!

READ AND FOLLOW ALL SAFETY AND INSTALLATION INSTRUCTIONS CAREFULLY. TURN OFF ELECTRICAL POWER BEFORE STARTING INSTALLATION.

WARNING - Before starting installation, disconnect power by turning off the circuit breaker or by removing the appropriate fuse at the fuse box. Do not install any luminaire assembly closer than 6" from any curtain or similar combustible materials. Risk of fire or electric shock. Luminaire wiring and electrical parts may be damaged when drilling for installation of LED retrofit kit. Check for enclosed wiring and components. Risk of fire or electric shock. LED Retrofit Kit installation requires knowledge of luminaires electrical systems. If not qualified, do not attempt installation. Contact a qualified electrician. Risk of fire or electric shock. Install this kit only in luminaires that have the construction features and dimensions shown in the photographs and/or drawings and where the input rating of the retrofit kit does not exceed the input rating of the luminaire. To prevent wiring damage or abrasion, do not expose wiring to edges of sheet metal or other sharp objects. Do not make or alter any open holes in an enclosure of wiring or electrical components during kit installation. **Consult a qualified electrician before installing. Work should be performed by qualified personnel.**

SAVE THESE INSTRUCTIONS

Follow wiring schematic for Absolute Light installation here: [PAR16 Wiring Schematic](#)



1. Drill a 13/16" hole into the ceiling.

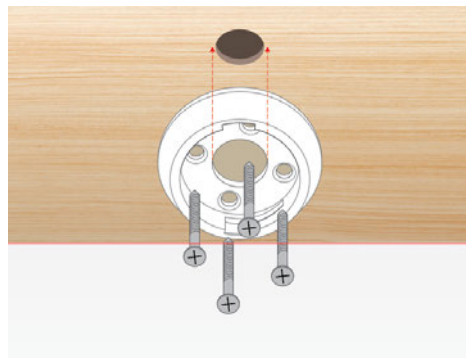

2. Align hole in fastener to hole in ceiling then screw into place (x4).

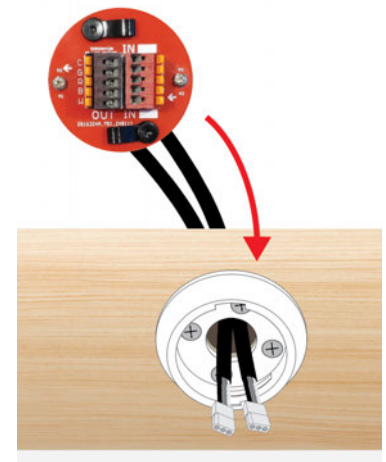

3. Fish wires from WAGO connector through ceiling and pull out of hole.



4. Connect wires from ceiling to fixture.



5. Line up slots (shown here in orange) then slide in and turn counter-clockwise to lock fixture in place.

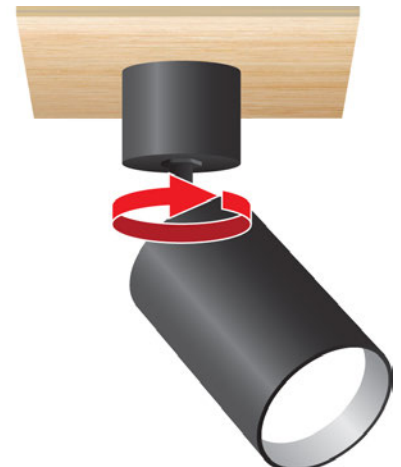

6. To remove, turn fixture clockwise.